

	AG-M880GF
50Hz	704KW/880KVA
50Hz	640KW/800KVA



●	MTU 12V2000G65
●	40°C
●	24V
●	:
●	IP23
●	H
●	
●	
●	
●	12V
●	
●	9dB
●	



V	Hz		COS	A	KWKVA	KWKVA
254/440	50	3	0.8	1154	704/880	640/800
240/415	50	3	0.8	1224	704/880	640/800
230/400	50	3	0.8	1270	704/880	640/800
220/380	50	3	0.8	1337	704/880	640/800

GB/T2820-97 eqv I SO8528

1 10%

12





/

MTU/12V2000G65

V 12

23.88L

x

130x 150 mm

16.0

1500rpm

765KW

ADEC



150m³/mi n

565

8.5kPa

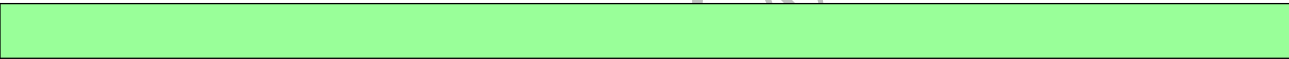

5kPa

54m³/mi n

1014m³/mi n

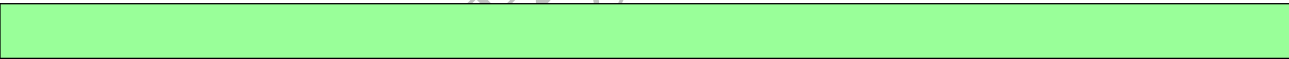

100%

202g/kwh

75%

203g/kwh

50%

210g/kwh

100%

161.2L/h



77L

0.5%

67L

620-750kPa



164L

102



GB755, BS5000, VDE0530, NEMING1- 22, I EC34- 1, CSA22 2 AS1359



:

/

3

Y

1

0.8

IP23

1000m

/

H/H

TIF

50

THF

2%

810KVA

94.4%

1.614m³/s



± 5%

± 1%

100%

+25%

-20%

6S

1%

5%

1.5%

100%

+12%

-10%

5S

" COMAP"

MCB

PNG

ATS

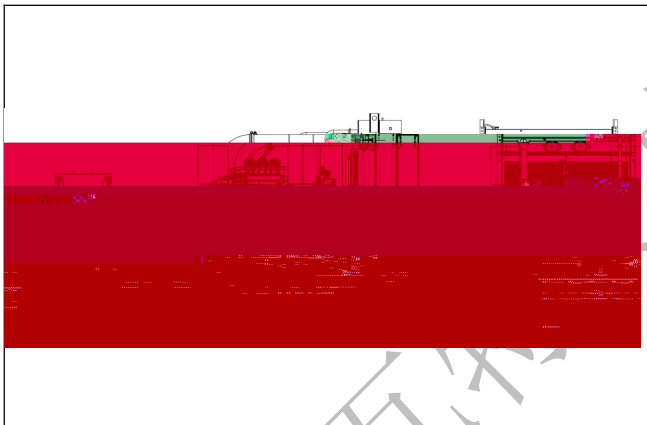

()

4200(mm) × 1650 mm × 2280 mm
7000kg

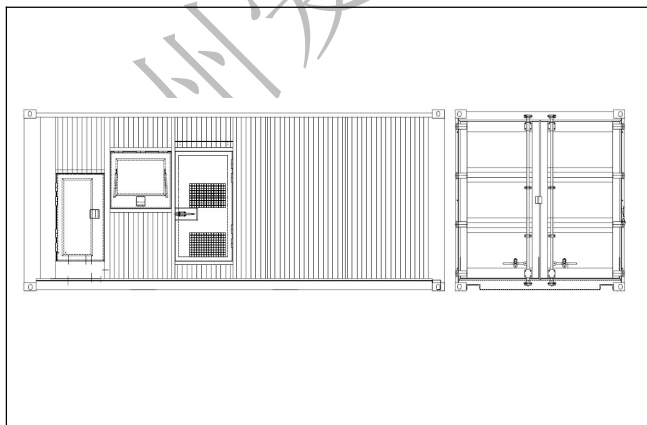

20

6058 mm × 2438 mm × 2591 mm
11000kg

5800 mm × 1800 mm × 2550 mm
10000kg

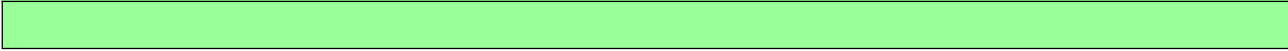

/ ATS

Conap

RS-232 Modbus

" " " " " "

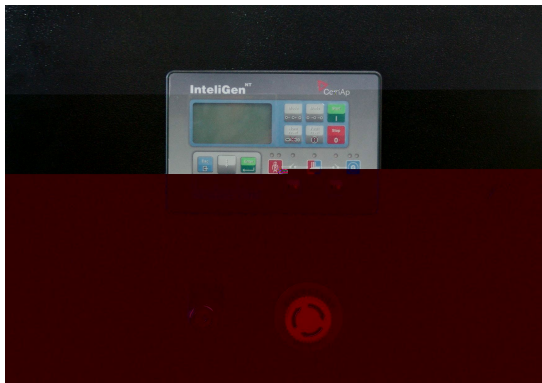

苏州爱